

THROTTLE ASSEMBLY

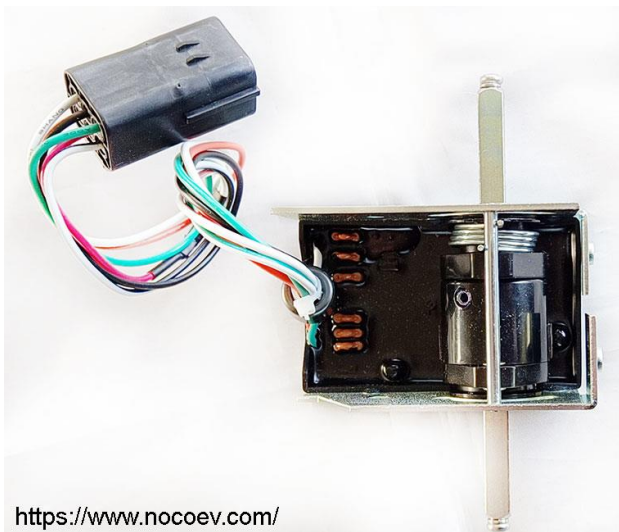

MODEL ET-165E

<https://www.noco-ev.com/>

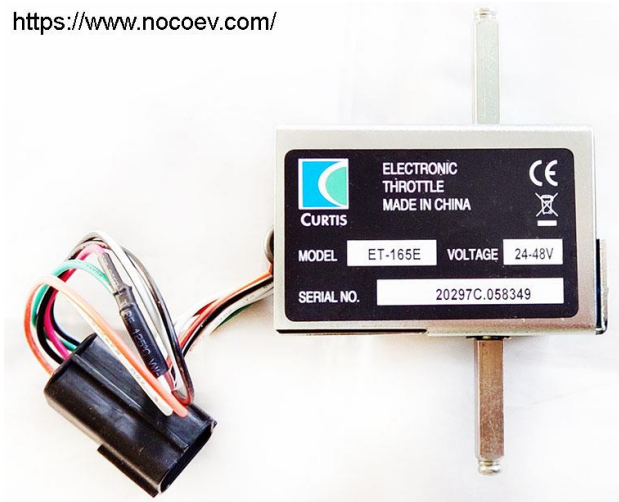

<https://www.noco-ev.com/>

DESCRIPTION

The Curtis throttle assembly provides an analog 0-5V output proportional to throttle position for interfacing with motor speed controllers.

APPLICATION

This electronic throttle is ideal for use in material handling, golf cars, on-road and other electric vehicle applications which require a 0-5V input for speed control.

FEATURES

- Hall effect sensors and solid state MOSFET contactor drivers minimize moving parts, thereby increasing reliability and Mean Time Between Failure.
- Symmetrical throttle response in both forward and reverse directions ensures smooth, concise acceleration and deceleration in both directions.
- Minimal deadband areas at both zero and full throttle positions eliminates hesitation when beginning to accelerate or decelerate.
- Environmental protection of major components through an epoxy layer over the circuit board assures operation in harsh environmental conditions.
- Wig-wag type throttle returns the throttle to neutral for convenience and safety.
- Input polarity protection to ensure no damage occurs to the throttle if it is incorrectly wired.
- Easy to install.

SPECIFICATIONS

- Operating voltage: 13 - 58VDC
- Throttle output range: 0 to 5 Volts
- Maximum throttle output: 5.3 Volts
- Minimum throttle output: 0 Volts
- Maximum deadband at zero throttle: 10 degrees
- Maximum deadband at full throttle: 10 degrees
- Forward/Reverse current: 1.5 amp max
- Symmetrical throttle response in both directions

NOCO SHOP

Website: <https://www.noco-evco.com/> - Email: info@noco-evco.com

THROTTLE ASSEMBLY



CURTIS

MODEL ET-165E

DIMENSIONS mm

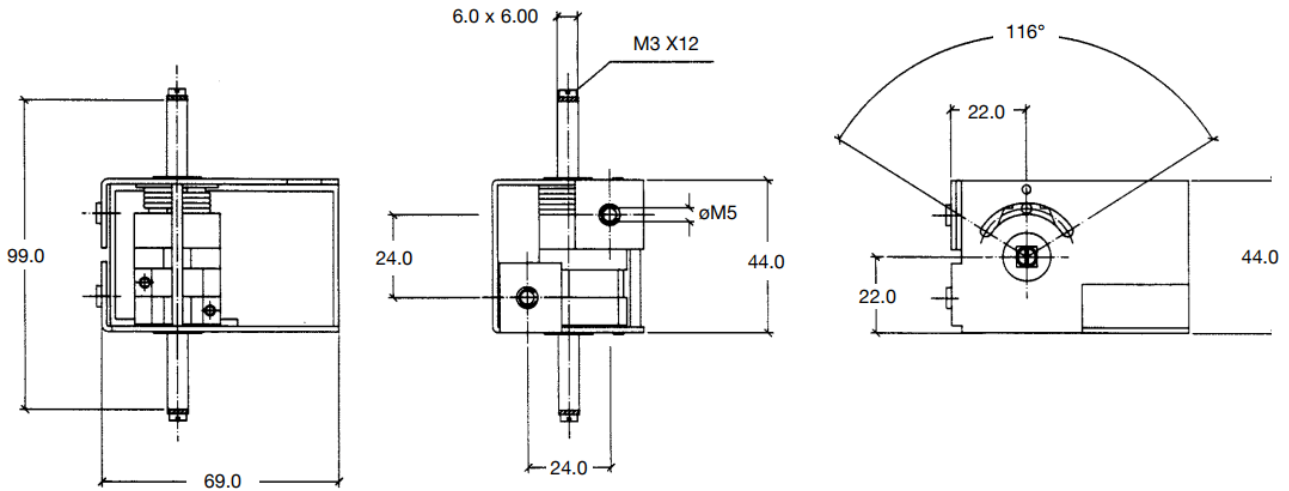

INSTALLATION

Mounting: Two M5 screws

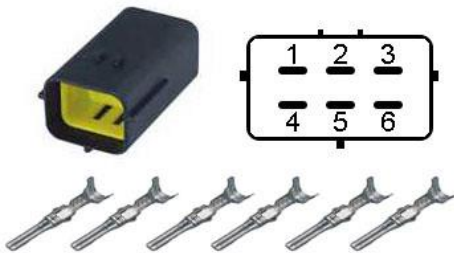

ET-165E Throttle

1	Battery + after KSI
2	0-5V output
3	Reverse
4	Forward
5	Battery -
6	Pot Lo

ET-165E Throttle

Mate-N-Lock Connector

Connector Model: DJ70616Y-1.8-11

Mating Connector Model: DJ70616Y-1.8-21

NOCO SHOP

Website: <https://www.noco-evco.com/> - Email: info@noco-evco.com