



CH-1

Tiller Head Electric Vehicle Control

Description

The tiller head CH-1 is a generic purpose control device, developed for material handling vehicles. Packaged in a rugged housing that offer an attractive and practical method of controlling 24-48V electric vehicles.



Application

Equipped with an emergency reverse switch, electronic throttle, and lift and lower switches, CH-1 is ideal for both indoor and outdoor vehicles such as pallet jacks, walkies, stackers and tow tractors.

Dimensions

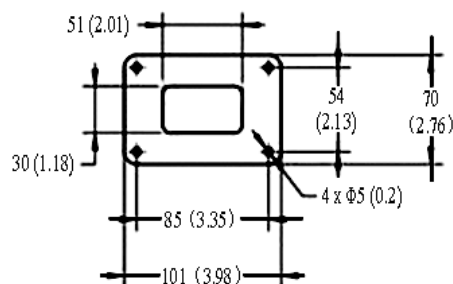
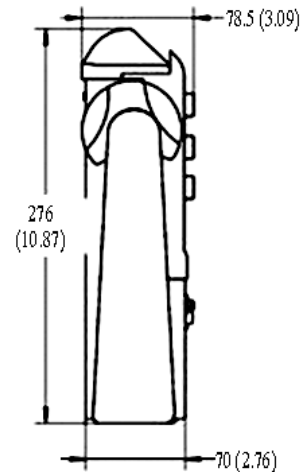
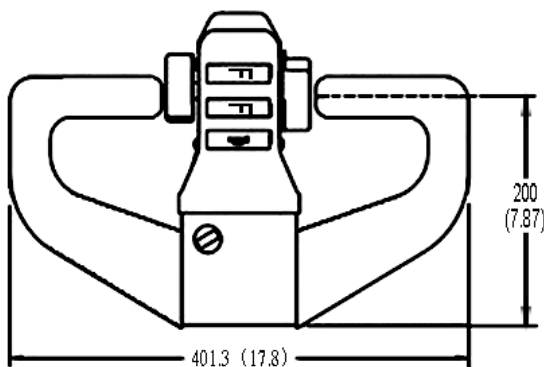

unit: mm (inch)

Model: CH-1

NOCO SHOP

Email: info@noco-evco.com - Website: <https://www.noco-evco.com/>



CH-1

Tiller Head Electric Vehicle Control

Characteristics

1. Input voltage: 24-48V DC
2. Throttle output: 0-5V
3. Max. Current (lift, lower and horn switches): 5A
4. Max. Current (forward and reverse switches): 1.5A

Connectors

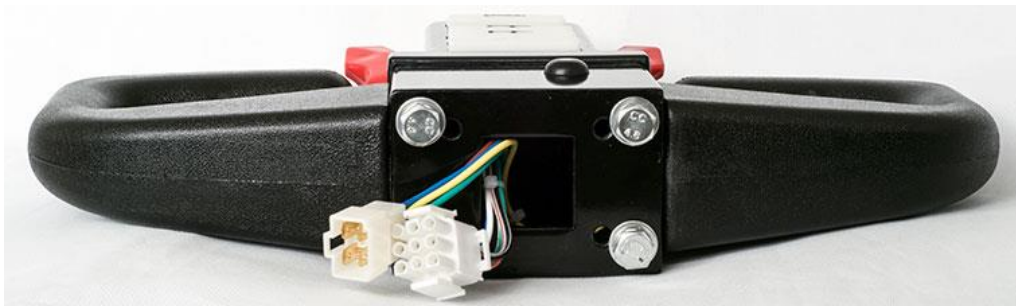

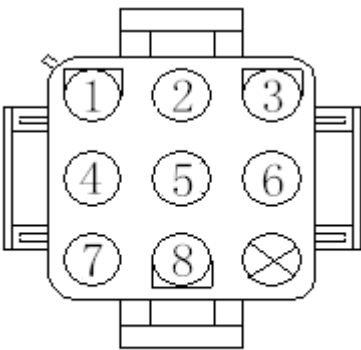
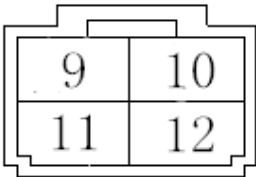
Connector	Contact Number	Function
 <p>TE 9-Pin Connector Model: 350782-1</p>	1	Throttle Ground (0 V)
	2	Battery +
	3	Reverse
	4	Forward
	5	Mode Change Switch
	6	Emergency Reverse Switch
	7	Battery –
	8	Throttle Signal (0-5 V)
 <p>4-Pin Connector Model: DJ7041-6.3-11</p>	9	Lower Switch
	10	Lifting Switch
	11	Public End
	12	Buzzer Switch

NOCO SHOP

Email: info@noco-evco.com - Website: <https://www.noco-evco.com/>